

GROUND JOINTS

ASTM publishes standard specifications for the designation, dimensions and tolerances for ground joints for use in laboratory in industrial equipment. These standards were developed to obtain dimensional interchangeability of taper-ground joints, taper-ground stopcocks and stoppers, spherical-ground joints and PTFE (Polytetrafluoroethylene) plugs for use in glass stopcocks.



This symbol designates Standard Taper Joints. The two parts that comprise this type of joint are referred to as “male” and “female”, or simply “inner” and “outer”.

Full-Length Taper-Ground Joints

Joint Size Designation	“A” Approximate Diameter at Small End mm	“B” Approximate Length of Ground Zone mm	“C” Diameter at Large End of Ground Zone mm
7/25	5.0	25	7.5
10/30	7.0	30	10.0
12/30	9.5	30	12.5
14/35	11.0	35	14.5
19/38	15.0	38	18.8
24/40	20.0	40	24.0
29/42	25.0	42	29.2
34/45	30.0	45	34.5
40/50	35.0	50	40.0
45/50	40.0	50	45.0
50/50	45.0	50	50.0
55/50	50.0	50	55.0
60/50	55.0	50	60.0
71/60	65.0	60	71.0
103/60	97.0	60	103.0

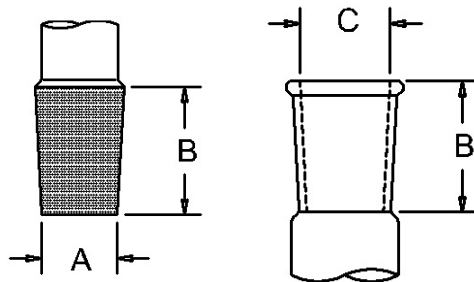

Medium-Length Taper-Ground Joints

Joint Size Designation	Approximate Diameter at Small End mm	Approximate Length of Ground Zone mm	Diameter at Large End of Ground Zone mm
5/12	3.8	12	5.0
7/15	6.0	15	7.5
10/18	8.2	18	10.0
12/18	10.7	18	12.5
14/20	12.5	20	14.5
19/22	16.6	22	18.8
24/25	21.5	25	24.0
29/26	26.6	26	29.2
34/28	31.7	28	34.5
40/34	36.5	35	40.0

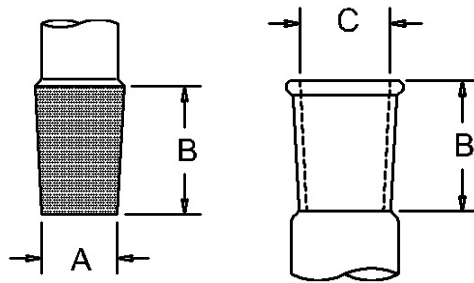

Short-Length Taper-Ground Joints

Joint Size Designation	Approximate Diameter at Small End mm	Approximate Length of Ground Zone mm	Diameter at Large End of Ground Zone mm
5/8	4.2	8	5.0
7/10	6.5	10	7.5
10/7	9.3	7	10.0
10/10	9.0	10	10.0
12/10	11.5	10	12.5
14/10	13.5	10	14.5
19/10	17.8	10	18.8
24/12	22.8	12	24.0
29/12	28.0	12	29.2
34/12	33.3	12	34.5
40/12	38.8	12	40.0
45/12	43.8	12	45.0
50/12	48.8	12	50.0
55/12	53.8	12	55.0
60/12	58.8	12	60.0
71/15	69.5	15	71.0